

How A District Leverage Other Resources



Green School Summit

Pasadena California

October 17 & 18

JANET HARTIN - UCCE

YING WANG - OKAPI ARCHITECTURE INC.

What Our District Did?

2

Our District Needs –

- Ø Green Area
- Ø Improvement With No Cost, and No Additional Work
- Ø Edible Garden

- Ø Leverage NGO's expertise
- Ø Finding Grant Opportunity
- Ø Identify Potential School Site
- Ø Have Principal Buy In
- Ø Committed in Utility Cost, DSA Permit, Long Term M & O Issue

Barriers???

3

- Ø Money
- Ø Security
- Ø DSA Process
- Ø Leadership and Commitment
- Ø Long Term Prospect

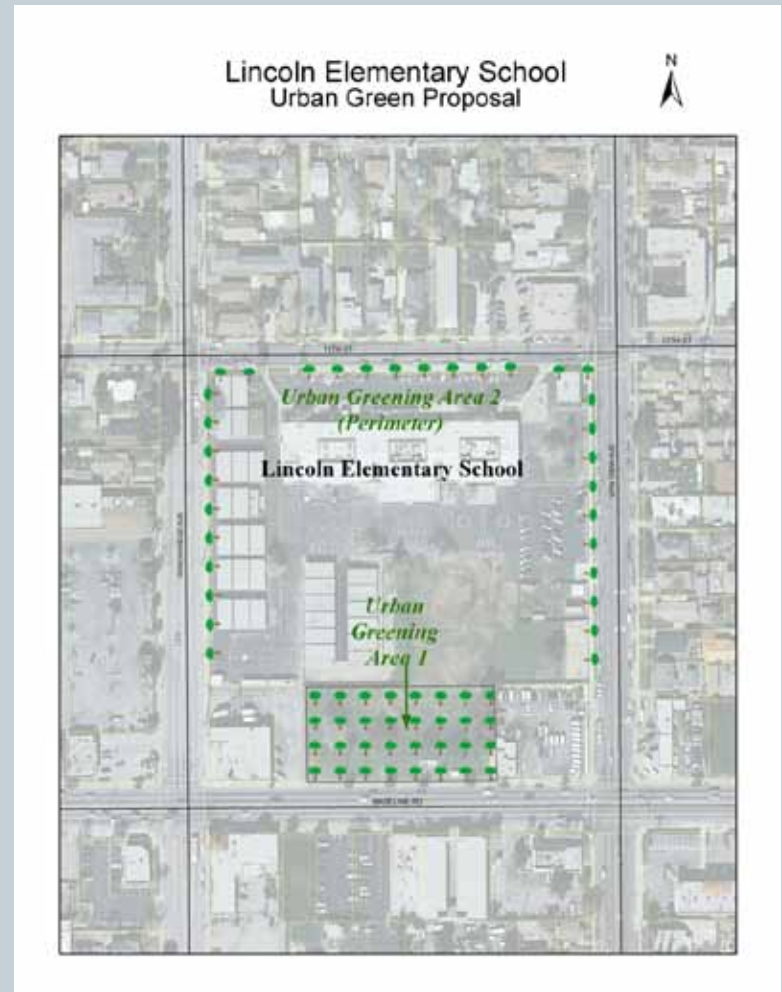

Open Discussion

4

∅ Dreams and Wishes

∅ Resources

∅ Barriers

∅ What is your role